

# *A Home Is A Home*

Sylvain Gelewski

26.10–16.11.2024

The third part of *The Court Jester* project, the installation *A Home Is Home*, explores the notions of nomadic habitat, ancestral land, borders, dispossession, forced displacement, and reconstruction. It uses the location of the Peripherie 8 space, situated on the border between Basel-City and Basel-Land, as both a chromatic and geographical reference. The pieces bear stigmata reminiscent of gutted buildings and the landscape seen from above in a war zone. The installation focuses on the Palestinian enclave of Gaza, a zone, a land, and a home for millions of people. It serves as a philosophical and personal reflection on issues of responsibility, information, and involvement, examining what it means to have—or lack thereof—a home, or not, within one's own country.

*How can we find objective and accurate information about the ongoing war if no international journalist is allowed to cover the conflict?*

*I won't forget the partisan machinations and political calculations, defying all common sense, humanity, and peace.*

*I won't forget all the "surgical strikes" by the IDF that tore apart buildings and dug ten-meter-deep holes in the ground.*

*I think of the Geneva Conventions, trampled on with each new incident.*

*Beni plays the situation like a deck of cards, making alliances with his knaves, turning laws and rules into his queens, thinking himself a king, always keeping an American ace up his sleeve, without even bothering to wear the joker's mask.*

*I think of all I want to say, and the only sentence that comes out in this moment: "Gaza, my heart bleeds when I think of you."*

*Missile launcher, human target, house of cards, rocket launcher, human shield, iron dome.*

*I think about slipping a watermelon into the thought bubble of a chat on Instagram instead of a comment.*

*I will not forget the equivalent of six Hiroshima bombs dropped on Gaza in one year.*

*I think of the numbers and reports every day. Human beings become statistics, existing only through their disappearance.*

*A land is a homeland.*

*A country is a house.*

*A territory is a refuge.*

*A home is a home.*

\*\*\*

Sylvain Gelewski is an artist and curator from Geneva (Switzerland). He is interested in lists, colours, political events, neurodivergence, and the value of work, through a play between norms and their most superfluous details. Recent solos: Sihl Delta, Zurich, CH (2024); Backbeatbolaget, Sandviken, SE (2023); Dogo Residenz, Lichtensteig, CH (2021); E-Werk, Freiburg im Breisgau, DE (2020). Recent group shows: Kunsthalle Trier, DE; Gowen Contemporary, Geneva, CH (2024); Ausstellungsraum Klingental, Basel, CH; Raum für Sichtbarkeit, Berlin, DE (2023); Flux Laboratory, Geneva, CH; der TANK, Basel, CH (2022); Cité internationale des arts, Paris, FR (2021); Centre d'Art Contemporain, Geneva, CH; Fabienne Levy Gallery, Lausanne, CH; Centre d'Art Contemporain, Yverdon-les-Bains, CH (2020).

Opening October 26th 2024, 6 – 8 pm

Performance with María Sabato, 7 pm

Opening Times: Friday/Sunday, 3 – 5 pm or by appointment

Finissage November 16th 2024, 5 – 7 pm

The exhibition is supported by the Christoph Merian Stiftung and with the support of the République et Canton de Genève.

[sylvaingelewski.com](http://sylvaingelewski.com)

[@syl\\_gelewski](https://www.instagram.com/syl_gelewski)

[Peripherie 8](#)

Holestrasse 8, 4054 Basel

[@peripherie8\\_offspace\\_basel](#)

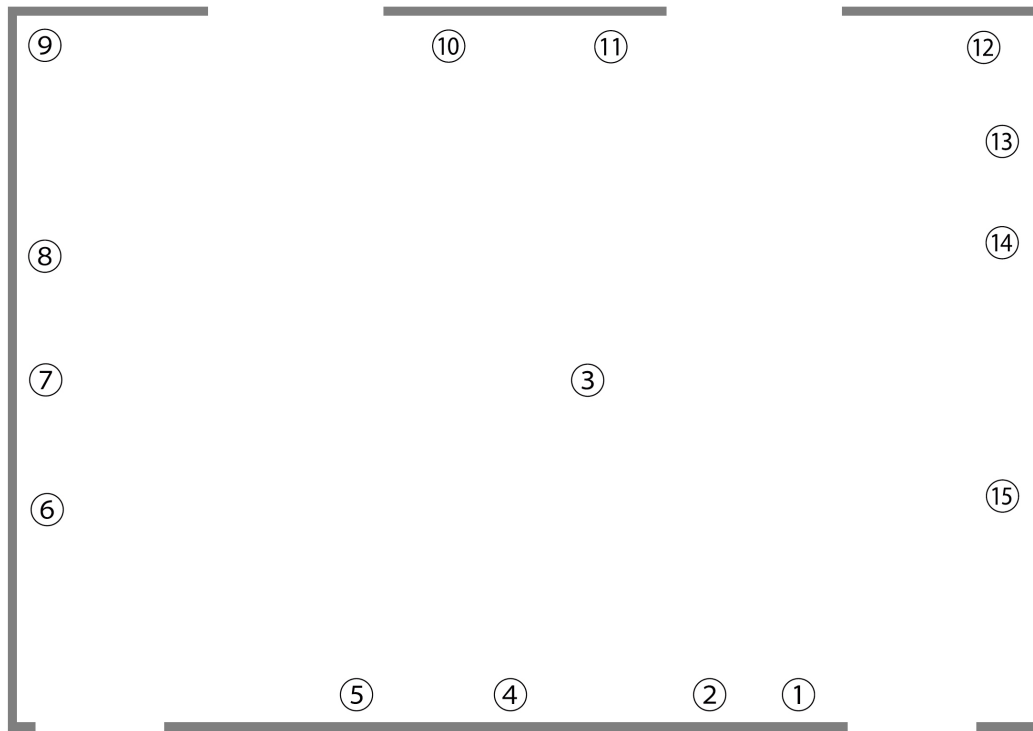

1. *Untitled (black & white)*, 27 x 21 x 1 cm, plaster, acrylic on found frame, 2023
2. *AHIAH (medium box)*, 40 x 31 x 7.5 cm, lacquer on scrap textile and canvas laminated on found wood box, plaster, 2024
3. *AHIAH (low table + lamp)*, 250 x 50 x 85 cm, lacquer, spray on scrap textile and canvas laminated on found antique table, metal, strings, plaster, collected broken porcelain and glass, coloured light, 2024
4. *The Court Jester 25 (Watermelon Resistance)*, 34 x 22 x 2.5 cm, oil, ink, marker on scrap linen canvas, lacquer on wooden frame, 2024
5. *Rafistolage 9*, 142 x 52 x 4 cm, oil on scrap canvas, cotton, jeans, strings, wood, 2023-2024
6. *The Court Jester 23 (Keffieh)*, 34 x 22 x 2.5 cm, oil, Indian ink, marker on scrap linen canvas, lacquer on wooden frame, 2024
7. *AHIAH (small box)*, 44 x 35 x 7.5 cm, lacquer on scrap textile and canvas laminated on found wood box, plaster, 2024
8. *The Court Jester 26 (Chimera)*, 34 x 22 x 2.5 cm, oil, marker on scrap linen canvas, lacquer on wooden frame, 2024
9. *AHIAH (chest + stick)*, 102 x 80 x 50 cm, lacquer on scrap textile and canvas laminated on found antique chest, metal, wood, plaster, cotton, glass, 2024
10. *Untitled (white)*, 25.5 x 19 x 1.5 cm, plaster, lacquer, acrylic on found frame, 2023
11. *Untitled (black)*, 25.5 x 19 x 2 cm, plaster, lacquer, acrylic on found frame, 2023
12. *AHIAH (newspaper + mask)*, 45 x 45 x 116 cm, lacquer on scrap textile and canvas laminated on found antique newspaper rack, wood, resin, plaster, polyester, cotton, glass, 2024
13. *AHIAH (stripes)*, 32 x 40 x 20 cm, lacquer on scrap textile and canvas laminated on found wood box, plaster, 2024
14. *Untitled (white) 2*, 25 x 25 x 2 cm, plaster, lacquer on found frame, 2023
15. *The Court Jester 24 (Uncle)*, 34 x 22 x 2.5 cm, oil, Indian ink, marker on scrap linen canvas, lacquer on wooden frame, 2024